

SUN VISOR FOR RENAULT T

MOUNTING INSTRUCTION

ASSEMBLY PROCEDURE

- 1 Measure and mark 8 points for attaching the sunvisor
- 2 Drill through the sheet metal with an 8.5mm drill bit
- 3 Insert the river nuts into the drilled holes press them in using special pliers
- 4 Prepare a sunvisor in place. Insert and tighten all screws one by one. Tighten all screws carefully. **Use original survivor screws**
- 5 If you have an additional mirror, install it according to the instructions below
- 6 The installation is complete

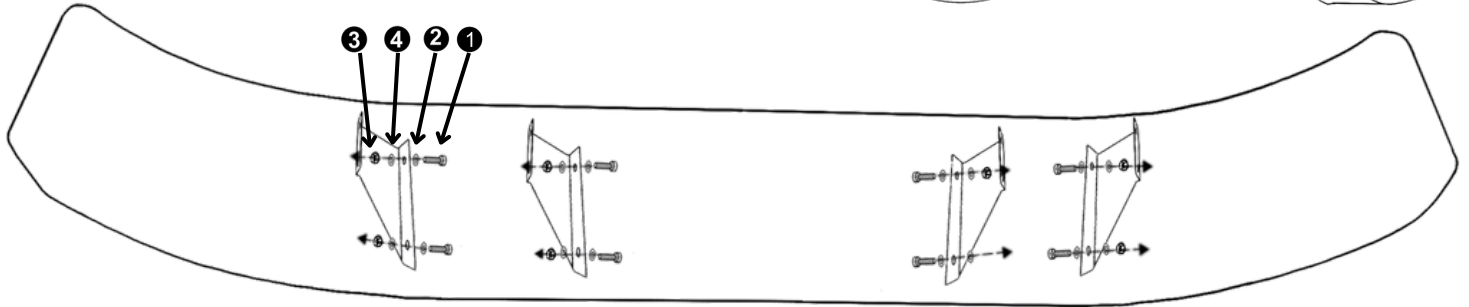
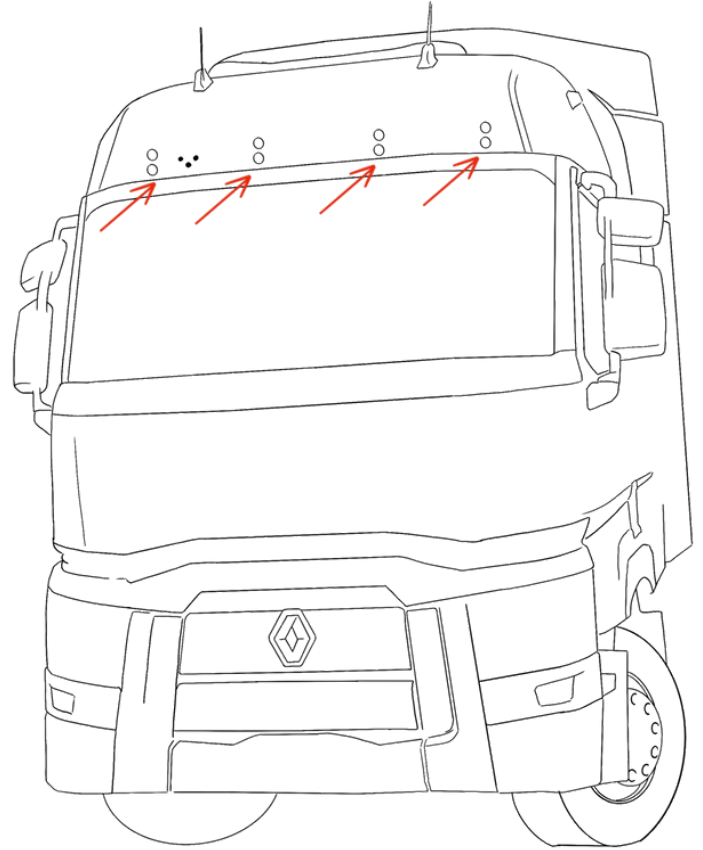

SUNVISOR PACKAGE CONTAINS

- 1 8x Screw M8 x 20mm
- 2 8x Washer M8 x 24mm
- 3 8x Lock Nut M8
- 4 8x Washer M8 x 16mm

front mirror mirror extension

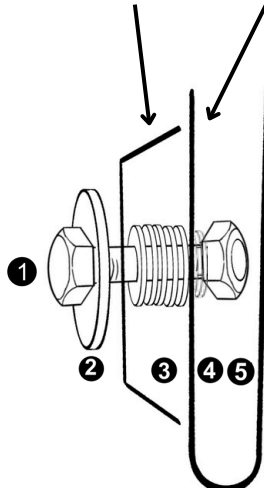

MIRROR EXTENSION PACKAGE CONTAINS

- 1 3x Screw M8 x 35mm
- 2 3x Washer M8 x 27mm
- 3 15x Washer M8 x 24mm
- 4 3x Washer M8 x 16mm
- 5 3x Nut M8

!SOLD SEPARATELY!

Mirror extension



SUN VISOR MARKER LIGHT MOUNTING INSTRUCTIONS

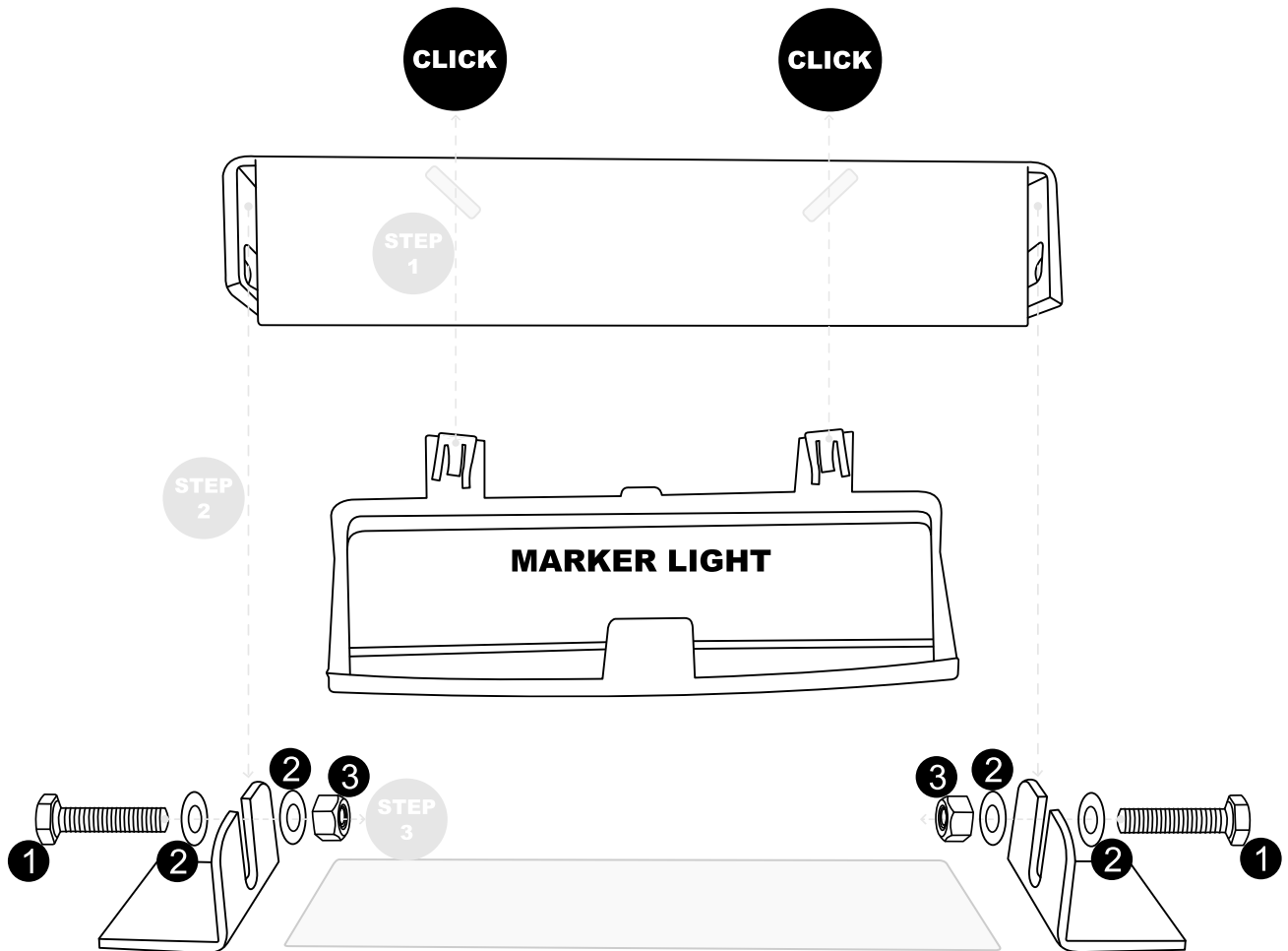

Package contains

- 1 2x Screw M5
- 2 4x Washer M5
- 3 2x Nut M5

