

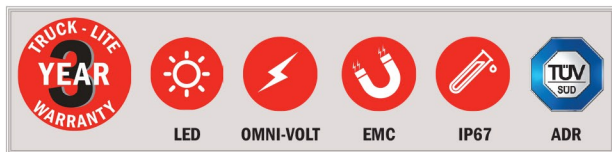

SS/89

High Powered LED Reverse Lamp



Beam Pattern

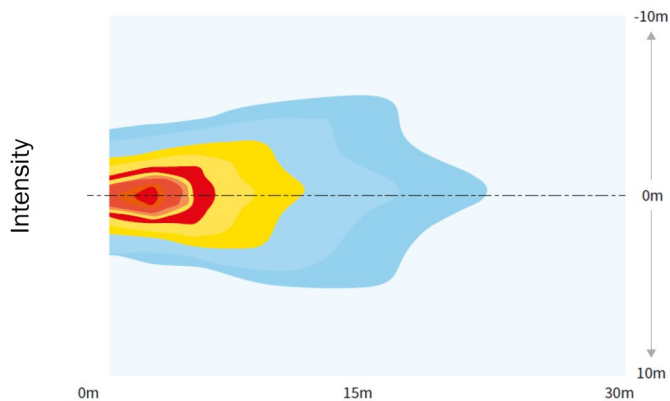

Dimensions:

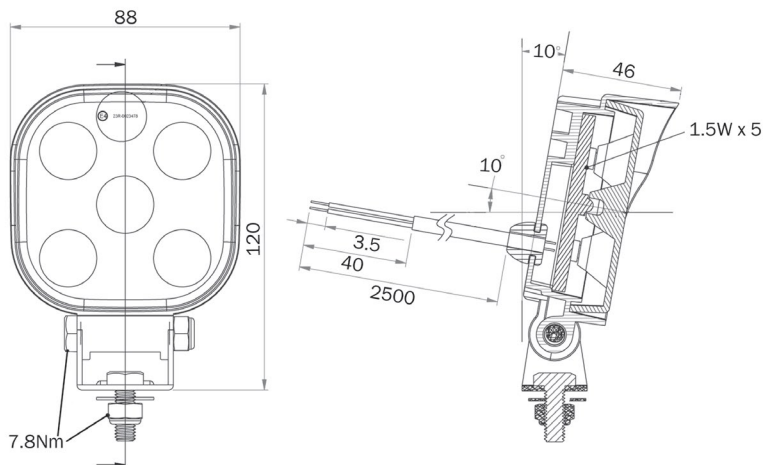

Part No.	SS/89005
Light Source	LED
Voltage	Omni-volt - 10/30V
Dimensions	L 88 x H 120 x D 46
Housing	Die-cast housing
Lens	Polycarbonate
Mount/Fixings	M8 Fixing
Connector	Fly-Lead, 2.5m harness length
Functions	High Powered Reverse
Warranty	3 Year
Approvals	ADR Approved, ECE, EMC
Testing	IP67
Lumen	500 Lumen
Beam Type	Reverse
Power	5 x 1.5W (7.5W)

Part Numbers

SS/89005 - High Powered LED Reverse Lamp (500 Lumen)